

* required information

Section 1 of 17

You can save the form at any time and resume it later. You do not need to be logged in when you resume.

System reference

This is the unique reference for this application generated by the system.

Your reference

You can put what you want here to help you track applications if you make lots of them. It is passed to the authority.

Are you an agent acting on behalf of the applicant?

- Yes No

Put "no" if you are applying on your own behalf or on behalf of a business you own or work for.

Applicant Details

* First name

* Family name

You must enter a valid e-mail address

* E-mail

You must enter a telephone number

Main telephone number

Include country code.

Other telephone number

- Indicate here if the applicant would prefer not to be contacted by telephone

Is the applicant:

- Applying as a business or organisation, including as a sole trader
 Applying as an individual

A sole trader is a business owned by one person without any special legal structure. Applying as an individual means the applicant is applying so the applicant can be employed, or for some other personal reason, such as following a hobby.

Applicant Business

* Is the applicant's business registered in the UK with Companies House?

- Yes No

* Registration number

* Business name

If the applicant's business is registered, use its registered name.

Continued from previous page...

* VAT number

Put "none" if the applicant is not registered for VAT.

* Legal status

* Applicant's position in the business

Home country

The country where the applicant's headquarters are.

Registered Address

Address registered with Companies House.

* Building number or name

* Street

District

* City or town

County or administrative area

* Postcode

* Country

Agent Details

* First name

* Family name

* E-mail

Main telephone number

Include country code.

Other telephone number

Indicate here if you would prefer not to be contacted by telephone

Are you:

- An agent that is a business or organisation, including a sole trader
- A private individual acting as an agent

A sole trader is a business owned by one person without any special legal structure.

Agent Business

* Is your business registered in the UK with Companies House? Yes No

* Registration number

* Business name

If your business is registered, use its registered name.

* VAT number

Put "none" if you are not registered for VAT.

Continued from previous page...

* Legal status

* Your position in the business

Home country

The country where the headquarters of your business is located.

Agent Registered Address

Address registered with Companies House.

* Building number or name

* Street

District

* City or town

County or administrative area

* Postcode

* Country

Section 2 of 17

APPLICATION DETAILS

This application cannot be used to vary the licence so as to extend the period for which the licence has effect or to vary substantially the premises to which it relates. If you wish to make that type of change to the premises licence, you should make a new premises licence application under section 17 of the Licensing Act 2003.

I/we, as named in section 1, being the premises licence holder, apply to vary a premises licence under section 34 of the Licensing Act 2003 for the premises described in section 2 below.

* Premises Licence Number

Are you able to provide a postal address, OS map reference or description of the premises?

Address OS map reference Description

Postal Address Of Premises

Building number or name

Street

District

City or town

County or administrative area

Postcode

Country

Premises Contact Details

Telephone number

Continued from previous page...

Non-domestic rateable value of premises (£)

47,250

Section 3 of 17

VARIATION

Do you want the proposed variation to have effect as soon as possible?

Yes No

Date variation to take effect from

/ /
dd mm yyyy

Do you want the proposed variation to have effect in relation to the introduction of the late night levy?

Yes No

You do not have to pay a fee if the only purpose of the variation for which you are applying is to avoid becoming liable to the late night levy.

If your proposed variation would mean that 5,000 or more people are expected to attend the premises at any one time, state the number expected to attend

Describe Briefly The Nature Of The Proposed Variation

Describe the premises. For example the type of premises, its general situation and layout and any other information which could be relevant to the licensing objectives. Where your application includes off-supplies of alcohol and you intend to provide a place for consumption of these off-supplies, you must include a description of where the place will be and its proximity to the premises.

1. EXTEND THE SALE OF ALCOHOL HOURS TO 24 HOURS PER DAY, SEVEN DAYS PER WEEK.
2. ADD THE PROVISION OF LATE NIGHT REFRESHMENT (LNR) 23.00-05.00 HOURS PER DAY, SEVEN DAYS PER WEEK.
3. EXTEND THE CURRENT FOOTPRINT AND CHANGE THE INTERNAL LAYOUT OF THE PREMISE AND THEREFORE THE PLAN WHICH IS CURRENTLY ATTACHED TO THE PREMISES LICENCE.
4. REMOVE THE CONDITIONS STATED UNDER ANNEX C: PERMITTED HOURS-SALE OF ALCOHOL FROM THE LICENCE AS THEY WILL NO LONGER BE REQUIRED (SUBJECT TO THE INCREASED SALE OF ALCOHOL HOURS BEING GRANTED.)

Section 4 of 17

PROVISION OF PLAYS

Will the schedule to provide plays be subject to change if this application to vary is successful?

Yes No

Section 5 of 17

PROVISION OF FILMS

Will the schedule to provide films be subject to change if this application to vary is successful?

Yes No

Continued from previous page...

Section 6 of 17

PROVISION OF INDOOR SPORTING EVENTS

Will the schedule to provide indoor sporting events be subject to change if this application to vary is successful?

- Yes No

Section 7 of 17

PROVISION OF BOXING OR WRESTLING ENTERTAINMENTS

Will the schedule to provide boxing or wrestling entertainments be subject to change if this application to vary is successful?

- Yes No

Section 8 of 17

PROVISION OF LIVE MUSIC

Will the schedule to provide live music be subject to change if this application to vary is successful?

- Yes No

Section 9 of 17

PROVISION OF RECORDED MUSIC

Will the schedule to provide recorded music be subject to change if this application to vary is successful?

- Yes No

Section 10 of 17

PROVISION OF PERFORMANCES OF DANCE

Will the schedule to provide performances of dance be subject to change if this application to vary is successful?

- Yes No

Section 11 of 17

PROVISION OF ANYTHING OF A SIMILAR DESCRIPTION TO LIVE MUSIC, RECORDED MUSIC OR PERFORMANCES OF DANCE

Will the schedule to provide anything similar to live music, recorded music or performances of dance be subject to change if this application to vary is successful?

- Yes No

Section 12 of 17

PROVISION OF LATE NIGHT REFRESHMENT

Will the schedule to provide late night refreshment be subject to change if this application to vary is successful?

- Yes No

Continued from previous page...

Standard Days And Timings

MONDAY

Start

End

Start

End

Provide timings in 24 hour clock (e.g., 16:00) and only give details for the days of the week when you intend the premises to be used for the activity.

TUESDAY

Start

End

Start

End

WEDNESDAY

Start

End

Start

End

THURSDAY

Start

End

Start

End

FRIDAY

Start

End

Start

End

SATURDAY

Start

End

Start

End

SUNDAY

Start

End

Start

End

Will the provision of late night refreshment take place indoors or outdoors or both?

- Indoors Outdoors Both

Where taking place in a building or other structure select as appropriate. Indoors may include a tent.

State type of activity to be authorised, if not already stated, and give relevant further details, for example (but not exclusively) whether or not music will be amplified or unamplified.

THE PROVISION OF HEATED SNACK FOODS (E.G SAUSAGE ROLLS, PANINNIS, PASTIES ETC) AND HOT DRINKS.

State any seasonal variations.

For example (but not exclusively) where the activity will occur on additional days during the summer months.

Continued from previous page...

Non standard timings. Where the premises will be used for the provision of late night refreshment at different times from those listed above, list below.

For example (but not exclusively), where you wish the activity to go on longer on a particular day e.g. Christmas Eve.

Section 13 of 17

SUPPLY OF ALCOHOL

Will the schedule to supply alcohol be subject to change if this application to vary is successful?

- Yes No

Standard Days And Timings

MONDAY

Start

End

Start

End

Provide timings in 24 hour clock (e.g., 16:00) and only give details for the days of the week when you intend the premises to be used for the activity.

TUESDAY

Start

End

Start

End

WEDNESDAY

Start

End

Start

End

THURSDAY

Start

End

Start

End

FRIDAY

Start

End

Start

End

SATURDAY

Start

End

Start

End

Continued from previous page...

SUNDAY

Start

End

Start

End

Will the sale of alcohol be for consumption?

- On the premises Off the premises Both

If the sale of alcohol is for consumption on the premises select on, if the sale of alcohol is for consumption away from the premises select off. If the sale of alcohol is for consumption on the premises and away from the premises select both.

State any seasonal variations.

For example (but not exclusively) where the activity will occur on additional days during the summer months.

Non-standard timings. Where the premises will be used for the supply of alcohol at different times from those listed above, list below.

For example (but not exclusively), where you wish the activity to go on longer on a particular day e.g. Christmas Eve.

Section 14 of 17

ADULT ENTERTAINMENT

Highlight any adult entertainment or services, activities, or other entertainment or matters ancillary to the use of the premises that may give rise to concern in respect of children.

Provide information about anything intended to occur at the premises or ancillary to the use of the premises which may give rise to concern in respect of children, regardless of whether you intend children to have access to the premises, for example (but not exclusively) nudity or semi-nudity, films for restricted age groups etc gambling machines etc.

NONE

Section 15 of 17

HOURS PREMISES ARE OPEN TO THE PUBLIC

Standard Days And Timings

MONDAY

Start

End

Start

End

Provide timings in 24 hour clock (e.g., 16:00) and only give details for the days of the week when you intend the premises to be used for the activity.

Continued from previous page...

TUESDAY

Start	<input type="text" value="00:00"/>	End	<input type="text" value="24:00"/>
Start	<input type="text"/>	End	<input type="text"/>

WEDNESDAY

Start	<input type="text" value="00:00"/>	End	<input type="text" value="24:00"/>
Start	<input type="text"/>	End	<input type="text"/>

THURSDAY

Start	<input type="text" value="00:00"/>	End	<input type="text" value="24:00"/>
Start	<input type="text"/>	End	<input type="text"/>

FRIDAY

Start	<input type="text" value="00:00"/>	End	<input type="text" value="24:00"/>
Start	<input type="text"/>	End	<input type="text"/>

SATURDAY

Start	<input type="text" value="00:00"/>	End	<input type="text" value="24:00"/>
Start	<input type="text"/>	End	<input type="text"/>

SUNDAY

Start	<input type="text" value="00:00"/>	End	<input type="text" value="24:00"/>
Start	<input type="text"/>	End	<input type="text"/>

State any seasonal variations.

For example (but not exclusively) where the activity will occur on additional days during the summer months.

Non standard timings. Where you intend to use the premises to be open to the members and guests at different times from those listed above, list below.

For example (but not exclusively), where you wish the activity to go on longer on a particular day e.g. Christmas Eve.

Continued from previous page...

Identify those conditions currently imposed on the licence which you believe could be removed as a consequence of the proposed variation you are seeking.

1. THE HOURS WHICH CURRENTLY RESTRICT THE SALE OF ALCOHOL (FOR CONSUMPTION OFF THE PREMISE) TO MONDAY TO SUNDAY 08.00-23.00 HOURS AND 10.00-22.30 HOURS ON SUNDAY.
2. THE CONDITION STATED UNDER ANNEX C; PERMITTED HOURS ALCOHOL SALES.

I have enclosed the premises licence

I have enclosed the relevant part of the premises licence

Reasons why I have failed to enclose the premises licence or relevant part of premises licence.

Section 16 of 17

LICENSING OBJECTIVES

Describe the steps you intend to take to promote the four licensing objectives:

a) General – all four licensing objectives (b,c,d,e)

List here steps you will take to promote all four licensing objectives together.

PLEASE SEE CONDITIONS WHICH WILL BE SENT VIA SEPARATE EMAIL AS THE GOV.UK WEBSITE WILL NOT ALLOW FOR THE DOCUMENT TO BE UPLOADED.

b) The prevention of crime and disorder

PLEASE SEE CONDITIONS WHICH WILL BE SENT VIA SEPARATE EMAIL AS THE GOV.UK WEBSITE WILL NOT ALLOW FOR THE DOCUMENT TO BE UPLOADED.

c) Public safety

PLEASE SEE CONDITIONS WHICH WILL BE SENT VIA SEPARATE EMAIL AS THE GOV.UK WEBSITE WILL NOT ALLOW FOR THE DOCUMENT TO BE UPLOADED.

d) The prevention of public nuisance

PLEASE SEE CONDITIONS WHICH WILL BE SENT VIA SEPARATE EMAIL AS THE GOV.UK WEBSITE WILL NOT ALLOW FOR THE DOCUMENT TO BE UPLOADED.

e) The protection of children from harm

PLEASE SEE CONDITIONS WHICH WILL BE SENT VIA SEPARATE EMAIL AS THE GOV.UK WEBSITE WILL NOT ALLOW FOR THE

Continued from previous page...

DOCUMENT TO BE UPLOADED.

Section 17 of 17

PAYMENT DETAILS

This fee must be paid to the authority. If you complete the application online, you must pay it by debit or credit card.

Variation Fees are determined by the non-domestic rateable value of the premises.

To find out a premises non domestic rateable value go to the Valuation Office Agency site at http://www.voa.gov.uk/business_rates/index.htm

Band A - No RV to £4300 £100.00

Band B - £4301 to £33000 £190.00

Band C - £33001 to £87000 £315.00

Band D - £87001 to £125000 £450.00*

Band E - £125001 and over £635.00*

*If the premises rateable value is in Bands D or E and the premises is primarily used for the consumption of alcohol on the premises then your are required to pay a higher fee

Band D - £87001 to £125000 £900.00

Band E - £125001 and over £1,905.00

If you own a large premise you are subject to additional fees based upon the number in attendance at any one time

Capacity 5000-9999 £1,000.00

Capacity 10000 -14999 £2,000.00

Capacity 15000-19999 £4,000.00

Capacity 20000-29999 £8,000.00

Capacity 30000-39999 £16,000.00

Capacity 40000-49999 £24,000.00

Capacity 50000-59999 £32,000.00

Capacity 60000-69999 £40,000.00

Capacity 70000-79999 £48,000.00

Capacity 80000-89999 £56,000.00

Capacity 90000 and over £64,000.00

* Fee amount (£)

DECLARATION

* I/we understand it is an offence, liable on conviction to a fine up to level 5 on the standard scale, under section 158 of the licensing act 2003, to make a false statement in or in connection with this application.

Ticking this box indicates you have read and understood the above declaration

This section should be completed by the applicant, unless you answered "Yes" to the question "Are you an agent acting on behalf of the applicant?"

* Full name

* Capacity

* Date / /
dd mm yyyy

Continued from previous page...

Once you're finished you need to do the following:

1. Save this form to your computer by clicking file/save as...
2. Go back to <https://www.gov.uk/apply-for-a-licence/premises-licence/guildford/change-1> to upload this file and continue with your application.

Don't forget to make sure you have all your supporting documentation to hand.

IT IS AN OFFENCE, LIABLE ON SUMMARY CONVICTION TO A FINE NOT EXCEEDING LEVEL 5 ON THE STANDARD SCALE, UNDER SECTION 158 OF THE LICENSING ACT 2003, TO MAKE A FALSE STATEMENT IN OR IN CONNECTION WITH THIS APPLICATION

OFFICE USE ONLY

Applicant reference number	<input type="text" value="SHELL HORSLEY"/>
Fee paid	<input type="text"/>
Payment provider reference	<input type="text"/>
ELMS Payment Reference	<input type="text"/>
Payment status	<input type="text"/>
Payment authorisation code	<input type="text"/>
Payment authorisation date	<input type="text"/>
Date and time submitted	<input type="text"/>
Approval deadline	<input type="text"/>
Error message	<input type="text"/>
Is Digitally signed	<input type="checkbox"/>

< Previous [1](#) [2](#) [3](#) [4](#) [5](#) [6](#) [7](#) [8](#) [9](#) [10](#) [11](#) [12](#) [13](#) [14](#) [15](#) [16](#) [17](#) Next >

Section M Describe the steps you intend to take to promote the four licensing objectives:

a) General-all four licensing objectives (b, c, d, e)

A suitable and sufficient CCTV system with recording facilities will be in place at site and will operate at all times the premise is open for licensable activities. Images can be made available upon reasonable request by the Police or other relevant officers of a responsible authority.

Staff will be trained with regard to their responsibilities in the retail sale of alcohol and regular refresher training will also be undertaken. Training records can be made available for inspection upon reasonable request by the Police or other relevant officers of a responsible authority.

A refusals book will be operated and maintained and will be produced to a relevant officer of the Police or other relevant officers of a responsible authority upon request.

A Challenge 25 policy will be operated at the premise, acceptable forms of identification are a passport, photocard driving licence and PASS accredited identification card.

Spirits will be located behind the counter.

b) The prevention of crime and disorder.

A suitable and sufficient CCTV system with recording facilities will be in place at site and will operate at all times the premise is open for licensable activities. Images can be made available upon reasonable request by the Police or other relevant officers of a responsible authority.

Spirits will be located behind the counter.

Staff will be trained with regard to their responsibilities in the retail sale of alcohol and regular refresher training will also be undertaken. Training records can be made available for inspection upon reasonable request by the Police or other relevant officers of a responsible authority.

c) Public Safety.

A suitable and sufficient CCTV system with recording facilities will be in place at site and will operate at all times the premise is open for licensable activities. Images can be made available upon reasonable request by the Police or other relevant officers of a responsible authority.

d) Prevention of public nuisance.

Staff will be trained with regard to their responsibilities in the retail sale of alcohol and regular refresher training will also be undertaken. Training records can be made available for inspection upon reasonable request by the Police or other relevant officers of a responsible authority.

e) The protection of children from harm.

Staff will be trained with regard to their responsibilities in the retail sale of alcohol and regular refresher training will also be undertaken. Training records can be made available for inspection upon reasonable request by the Police or other relevant officers of a responsible authority.

A refusals book will be operated and maintained and will be produced to a relevant officer of the Police or other relevant officers of a responsible authority upon request.

A Challenge 25 policy will be operated at the premise, acceptable forms of identification are a passport, photocard driving licence and PASS accredited identification card.

Spirits will be located behind the counter.

**General description supplementary to the premises licence variation
application for:**

SHELL UK OIL PRODUCTS LIMITED

SHELL HORSLEY
GUILDFORD ROAD
EAST HORSLEY
LEATHERHEAD
SURREY
KT24 6TA

Convenience Store Overview.

This is a well-established convenience store site trading under Shell UK Oil Products Limited but operated by Raj Cluster Limited. The site currently holds a premises licence which authorises the sale of alcohol Monday to Saturday 08.00-23.00 hours and Sunday 10.00-22.30 hours. The site is due to be refurbished in August 2015.

The Convenience Store.

The convenience store is a purpose built store and has been designed to serve passing trade and the local community. The convenience store trades under the company's own format. The store stocks a range of fresh foods and dairy produce, alcohol, groceries and other domestic products and also offers 'express' lunch and coffee facilities. In addition dry fuel products such as BBQ charcoal/kindling/logs are available.

The Operation.

The convenience store is operated by the Manager, assisted by a team of full and part time staff. The Designated Premises Supervisor, is trained and certified through an accredited scheme and is responsible for training all staff-utilising the Lockett & Co Due Diligence pack-and keeping complete training records. The Challenge 25 trading initiative is used supported by the refusals system with records kept in the Refusals Log. Litter bins are located inside the store and on the forecourt and daily litter picks are carried out as part of the site operation.

Security.

The internal and external digital CCTV system benefits from a recorder with 31 day image retention and recordings can be made available to Police and other enforcement agencies as needed.

The following two pages contain an overview of the Lockett & Co Due Diligence package.

LOCKETT & CO DUE DILIGENCE PACKAGE OVERVIEW

Lockett & Co will provide each licensed site with a complete due diligence package to consisting of the following material:

1. A Premises Licence Manual:

The manual consists of all the relevant information and guidance the licence holder would require relating to the premises licence and the requirements under the Licensing Act 2003. There is a location within the manual to store Part A of the premises licence and instruction provided regarding the requirement of the Section 57 notice and Part B Summary being displayed.

2. Staff Training Manual:

This manual is designed to enable the licence holder to undertake regular in house staff training relating to alcohol and age restricted products to ensure that all staff members including any new members of staff understand their legal duties and what the requirements are under the Licensing Act 2003 for alcohol and age restricted products and the penalties that may be applicable if the law is not adhered to.

3. Premises Refusals Log:

The log is to enable all staff to record all details of any refused sales to customers (for example if they are underage, do not have any ID, etc). The log allows all refusals to be kept in one place and provides the detailed information that is required under the Licensing Act 2003, which can then be produced at any time upon request to the Police, Trading Standards or other relevant officer to ensure that staff has been compliant with the requirements. This log is also signed off by the relevant DPS or site manager on a regular basis to ensure compliance.

4. Premises Incident Log:

The log is to enable staff to record any incidents that occur at the premises (for example theft, non-payment for goods, drive offs, acts of aggression or violence, etc).

5. Refusals Cards Alcohol:

The cards are for the staff members serving customers to give out to the customer when they are refused service when trying to purchase alcohol, telling them why they were refused. The use of the card can assist in reducing potential confrontation.

6. Refusals Cards Age Restricted:

The cards are for the staff members serving customers to give out to a customer when they are refused service for age restricted products, telling them why they were refused. The use if the card can assist in reducing potential confrontation.

7. U 25 Drink Awareness Badges:

The badges are for staff members to wear on their uniform, to identify to customers that they will be requesting ID from anyone who appears to be under the age of 25 when purchasing alcohol and age restricted products.

8. U 25 Drink Awareness Posters (per set A3, A4 & A2):

The posters are provided for the premises licence holder as a set of four to display in and around the premise, the four posters are as follows: 1. Advises that anyone who appears to be under the age of 25 will be asked for ID when purchasing alcohol, 2. Advises it is an offence to purchase or attempt to purchase alcohol on behalf of anyone who is under the age of 18. 3. Advises that it is a criminal offence to buy alcohol on behalf of a child. 4. Advises that anyone who appears to be under the age of 25 will be asked to produce ID when buying any age restricted product.

9. Tobacco Posters

The posters are for the premises licence holder to display on or near to the cigarette gantry that it is illegal to sell tobacco products to anyone under the age of 18. The poster meets the legislative requirements that the retailer must display in respect of tobacco sales.

10. Staff Guide to Selling Alcohol and Age Restricted Products Booklet:

The small booklet is provided to each member of staff at the premises and is distributed to them as part of their in house training, it is designed as an easy guide for staff members to refer to regarding their responsibilities with regard to the sale of alcohol and age restricted products.

Please note: Any legislative changes will be advised to the premises licence holder the changes will also be updated within the material provided to each site as and when it is required.



Licensing Act 2003

GUPLA0201

Premises Licence

Part 1 - Premises Details

POSTAL ADDRESS OF PREMISES, OR IF NONE, ORDANCE SURVEY MAP REFERENCE OR DESCRIPTION

Shell Horsley

Guildford Road, East Horsley, Leatherhead, Surrey, KT24 6TA.

Telephone 01483 286 130

WHERE THE LICENCE IS TIME LIMITED THE DATES

Not applicable

LICENSABLE ACTIVITIES AUTHORISED BY THE LICENCE

- the sale by retail of alcohol

THE TIMES THE LICENCE AUTHORISES THE CARRYING OUT OF LICENSABLE ACTIVITIES

Activity (and Area if applicable)	Description	Time From	Time To
M. The sale by retail of alcohol for consumption OFF the premises only	Monday to Saturday	8:00am	11:00pm
	Sunday	10:00am	10:30pm

THE OPENING HOURS OF THE PREMISES

Description	Time From	Time To
Monday to Sunday	Midnight	Midnight No Fixed Times

WHERE THE LICENCE AUTHORISES SUPPLIES OF ALCOHOL WHETHER THESE ARE ON AND / OR OFF SUPPLIES

- M. The sale by retail of alcohol for consumption OFF the premises only

Part 2

NAME, (REGISTERED) ADDRESS, TELEPHONE NUMBER AND EMAIL (WHERE RELEVANT) OF HOLDER OF PREMISES LICENCE

Shell UK OIL PRODUCTS LTD

Shell Centre, London, SE1 7NA.
Telephone 0207 934 1234

REGISTERED NUMBER OF HOLDER, FOR EXAMPLE COMPANY NUMBER, CHARITY NUMBER (WHERE APPLICABLE)

Shell UK OIL PRODUCTS LTD

3625633

Justine Fuller
Environmental Health Manager
Guildford Borough Council

Ref 31.07.15





GUILDFORD
BOROUGH

Licensing Act 2003

Premises Licence

GUPLA0201

NAME, ADDRESS AND TELEPHONE NUMBER OF DESIGNATED PREMISES SUPERVISOR WHERE THE PREMISES LICENCE AUTHORISES THE SUPPLY OF ALCOHOL

Satkunabalan SATKUNASINGHAM



PERSONAL LICENCE NUMBER AND ISSUING AUTHORITY OF PERSONAL LICENCE HELD BY DESIGNATED PREMISES SUPERVISOR WHERE THE PREMISES LICENCE AUTHORISES FOR THE SUPPLY OF ALCOHOL

Licence No. GUPA0829

Issued by Guildford

Ref 31.07.15



Justine Fuller
Environmental Health Manager
Guildford Borough Council



Premises Licence

ANNEXES

MANDATORY CONDITIONS

A: Sales of alcohol

1. No supply of alcohol may be made under the premises licence -
 - a. at a time when there is no designated premises supervisor in respect of the premises licence, or
 - b. at a time when the designated premises supervisor does not hold a personal licence or the personal licence is suspended
2. Every supply of alcohol under the premises licence must be made or authorised by a person who holds a personal licence

Mandatory Licensing Conditions (Off Sales)

1. The premises licence holder or club premises certificate holder must ensure that an age verification policy is adopted in respect of the premises in relation to the sale or supply of alcohol.
2. The designated premises supervisor in relation to the premises licence must ensure that the supply of alcohol at the premises is carried on in accordance with the age verification policy.
3. The policy must require individuals who appear to the responsible person to be under 18 years of age (or such older age as may be specified in the policy) to produce on request, before being served alcohol, identification bearing their photograph, date of birth and either-
 - a. a holographic mark, or
 - b. an ultraviolet feature.

B: Permitted price for alcohol

1. A relevant person shall ensure that no alcohol is sold or supplied for consumption on or off the premises for a price which is less than the permitted price.
2. For the purposes of the condition set out in paragraph 1-
 - a) "duty" is to be construed in accordance with the Alcoholic Liquor Duties Act 1979;
 - b) "permitted price" is the price found by applying the formula-
$$P=D+(D \times V)$$
where-
 - (i) P is the permitted price,
 - (ii) D is the amount of duty chargeable in relation to the alcohol as if the duty were charged on the date of the sale or supply of the alcohol, and
 - (iii) V is the rate of value added tax chargeable in relation to the alcohol as if the value added tax were charged on the date of the sale or supply of the alcohol;
 - c) "relevant person" means, in relation to premises in respect of which there is in force a premises licence-
 - (i) the holder of the premises licence,
 - (ii) the designated premises supervisor (if any) in respect of such a licence, or
 - (iii) the personal licence holder who makes or authorises a supply of alcohol under such a licence;
 - d) "relevant person" means, in relation to premises in respect of which there is in force a club premises certificate, any member or officer of the club present on the premises in a capacity which enables the member or officer to prevent the supply in question; and
 - e) "value added tax" means value added tax charged in accordance with the Value Added Tax Act 1994.
3. Where the permitted price given by Paragraph (b) of paragraph 2 would (apart from this paragraph) not be a whole number of pennies, the price given by that sub-paragraph shall be taken to be the price actually given by that sub-paragraph rounded up to the nearest penny.

Justine Fuller
Environmental Health Manager
Guildford Borough Council





Licensing Act 2003

GUPLA0201

Premises Licence

ANNEXES continued...

4. (1) Sub-paragraph (2) applies where the permitted price given by Paragraph (b) of paragraph 2 on a day ("the first day") would be different from the permitted price on the next day ("the second day") as a result of a change to the rate of duty or value added tax.
(2) The permitted price which would apply on the first day applies to sales or supplies of alcohol which take place before the expiry of the period of 14 days beginning on the second day.

C: Permitted hours-Sale of Alcohol

Alcohol shall not be sold or supplied except during permitted hours.
In this condition, permitted hours means:

- a) On weekdays, other than Christmas Day, 8 a.m. to 11 p.m.
- b) On Sundays, other than Christmas Day, 10 a.m. to 10.30 p.m.
- c) On Christmas Day, 12 noon to 3 p.m. and 7 p.m. to 10.30 p.m.
- d) On Good Friday, 8 a.m. to 10.30 p.m.

The above restrictions do not prohibit:

- a) during the first twenty minutes after the above hours, the taking of the alcohol from the premises, unless the alcohol is supplied or taken in an open vessel;
- b) the ordering of alcohol to be consumed off the premises, or the despatch by the vendor of the alcohol so ordered;
- c) the sale of alcohol to a trader or club for the purposes of the trade or club;
- d) the sale or supply of alcohol to any canteen or mess, being a canteen in which the sale or supply of alcohol is carried out under the authority of the Secretary of State or an authorised mess of members of Her Majesty's naval, military or air forces;



Justine Fuller
Environmental Health Manager
Guildford Borough Council



Licensing Act 2003

GUPLA0201

Premises Licence Summary

POSTAL ADDRESS OF PREMISES, OR IF NONE, ORDNANCE SURVEY MAP REFERENCE OR DESCRIPTION

Shell Horsley

Guildford Road, East Horsley, Leatherhead, Surrey, KT24 6TA.

Telephone 01483 286 130

WHERE THE LICENCE IS TIME LIMITED THE DATES

Not applicable

LICENSABLE ACTIVITIES AUTHORIZED BY THE LICENCE

- the sale by retail of alcohol

THE TIMES THE LICENCE AUTHORIZES THE CARRYING OUT OF LICENSABLE ACTIVITIES

Activity (and Area if applicable)	Description	Time From	Time To
M. The sale by retail of alcohol for consumption OFF the premises only	Monday to Saturday	8:00am	11:00pm
	Sunday	10:00am	10:30pm

THE OPENING HOURS OF THE PREMISES

Description	Time From	Time To
Monday to Sunday	Midnight	Midnight No Fixed Times

WHERE THE LICENCE AUTHORIZES SUPPLIES OF ALCOHOL WHETHER THESE ARE ON/AND/OR OFF SUPPLIES

- M. The sale by retail of alcohol for consumption OFF the premises only

NAME, (REGISTERED) ADDRESS OF HOLDER OF PREMISES LICENCE

Shell UK OIL PRODUCTS LTD

Shell Centre, London, SE1 7NA.
Telephone 0207 934 1234

REGISTERED NUMBER OF HOLDER, FOR EXAMPLE COMPANY NUMBER, CHARITY NUMBER (WHERE APPLICABLE)

Shell UK OIL PRODUCTS LTD

3625633

NAME OF DESIGNATED PREMISES SUPERVISOR WHERE THE PREMISES LICENCE AUTHORIZES THE SUPPLY OF ALCOHOL

Salkunabalan SATKUNASINGHAM

Justine Fuller
Environmental Health Manager
Guildford Borough Council

Ref 31.07.15





Licensing Act 2003

GUPLA0201

Premises Licence Summary

STATE WHETHER ACCESS TO THE PREMISES BY CHILDREN IS RESTRICTED OR PROHIBITED

00000000000000000000

00000000000000000000

00000000000000000000

00000000000000000000

00000000000000000000

00000000000000000000

00000000000000000000

00000000000000000000

00000000000000000000

00000000000000000000

00000000000000000000

00000000000000000000

00000000000000000000

00000000000000000000

Ref 31.07.15



Justine Fuller
Environmental Health Manager
Guildford Borough Council



Shell Horsle,
 Guildford Road
 East Horsley
 Leatherhead
 Surrey
 KT24 6TA

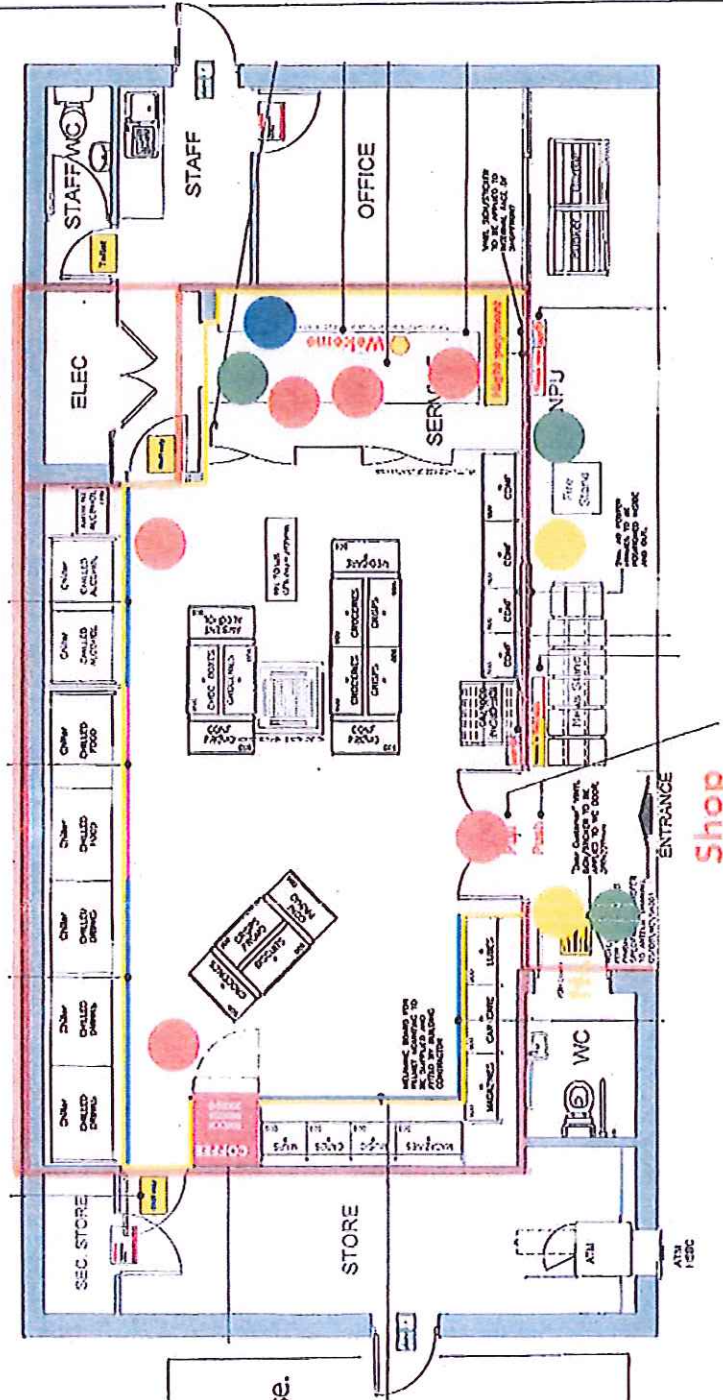

Key:

- Area to be licensed for the sale of alcohol for consumption off the premise.
- Fire extinguisher
- Fire Bucket
- CCTV
- Spirits behind counter

We certify this is a true copy of the original licence and summary

Date: September, 2013
 Scale: 1:100

**PUBLIC NOTICE OF AN APPLICATION TO VARY A
PREMISES LICENCE UNDER SECTION 34 OF THE
LICENSING ACT 2003**

Notice is hereby given that an application was made to the
GUILDFORD BOROUGH COUNCIL to vary a premises licence
under the above Act on **7TH AUGUST 2015**

Applicant: **SHELL UK OIL PRODUCTS LTD**

Address of premises: **SHELL HORSLEY, GUILDFORD
ROAD, EAST HORSLEY,
LEATHERHEAD, SURREY, KT24
6TA.**

Proposed variation to the licensable activities:

**1. TO EXTEND THE HOURS FOR THE SALE OF ALCOHOL
(FOR CONSUMPTION OFF THE PREMISE) TO 24 HOURS
PER DAY, SEVEN DAYS PER WEEK. 2. ADD THE
PROVISION OF LATE NIGHT REFRESHMENT 23.00-
05.00 HOURS SEVEN DAYS PER WEEK. 3. TO EXTEND
THE CURRENT FOOTPRINT AND CHANGE THE INTERNAL
LAYOUT OF THE PREMISE. 4. REMOVE CONDITIONS
WHICH WILL NO LONGER BE RELEVANT SHOULD THE
EXTENSION TO THE SALE OF ALCOHOL HOURS BE
GRANTED.**

The postal address of the Licensing Authority where the register is
kept and the application may be inspected is:

***GUILDFORD BOROUGH COUNCIL, MILLMEAD HOUSE,
MILLMEAD, GUILDFORD, GU2 4BB.**

Any person wishing to make representations on this matter shall
give notice, in writing, stating the nature and grounds for making
such representations to The Licensing Officer at the above
address* within 28 days of the date of this notice – by the
4TH SEPTEMBER 2015. Further information is available on the
web site www.guildford.gov.uk following the links.

It is an offence, under section 158 of the Licensing Act 2003, to
knowingly or recklessly make a false statement in or in connection
with an application and the maximum fine on summary conviction
of such an offence is £5000.

Lockett & Co – duly authorised agents